

Catalogue No: **CEP7-ED1DB**

OVERLOAD ELECTRONIC 3.2-16A FOR CA7-9/23

Motor Control and Drives > Motor Starting and Protection > Motor Protection > Sprecher + Schuh Overloads > Electronic Overload Relays > CEP7-ED1 Standard Electronic Overload Relays

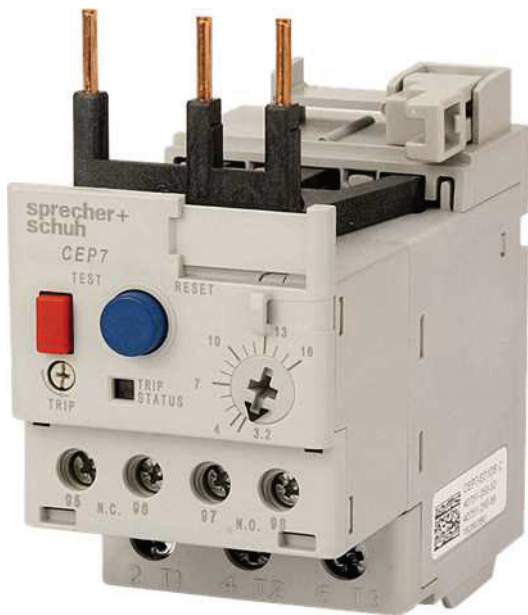

Representative Photo Only
(actual product may vary based on configuration selections)

CEP7-E Standard Electronic Overload Relay, 3.2-16.0A, (3-Phase), 1.5...7.5kW, for use with CA7-9...23, Trip Class 10, Manual Reset

- Wider current adjustment range (5:1) significantly reduces inventory requirements
- Extremely low heat generation results in cooler panels and switchboards
- Self-powered with no separate power supply connection required
- Advanced phase failure detection (typically 3 seconds)
- Visible trip indication
- Direct current measurement for precise thermal modelling ensures accurate motor protection
- Low voltage compatible contacts (17V, 5mA) – ideal with PLC systems
- Includes trip and alarm contacts – 1 N/C and 1N/O
- Unique latching mechanism and strengthened power connections provide greater mechanical connection with Sprecher + Schuh CA7 and CA6 contactors

SPECIFICATIONS

| | |
|-----------------------------------------|---------------------------|
| Component Type Motor Control and Drives | Electronic Overload |
| Current Range (A) | 3.2...16 |
| Approx kW | 1.5...7.5 |
| Details, Contactor | 100-C09...23 / CA7-9...23 |
| Trip Class | 10 |
| Reset | Manual Only |
| Contact Configuration | 1 NO + 1 NC |
| Test Function | Yes |
| Visible Trip Indicator | Yes |
| Rated Operation Voltage | 690 V AC |

REFERENCES

| | |
|---------------------------------------------|---|
| IECEX Certificate | - |
| Supplier Declaration of Conformity: | - |
| Installation Guide: | - |
| User Manual: | - |
| Manufacturer Datasheet: | - |
| Manufacturer Catalogue & Product Selection: | - |

Catalogue No: **CEP7-ED1DB**

OVERLOAD ELECTRONIC 3.2-16A FOR CA7-9/23

Motor Control and Drives > Motor Starting and Protection > Motor Protection > Sprecher + Schuh Overloads > Electronic Overload Relays > CEP7-ED1 Standard Electronic Overload Relays

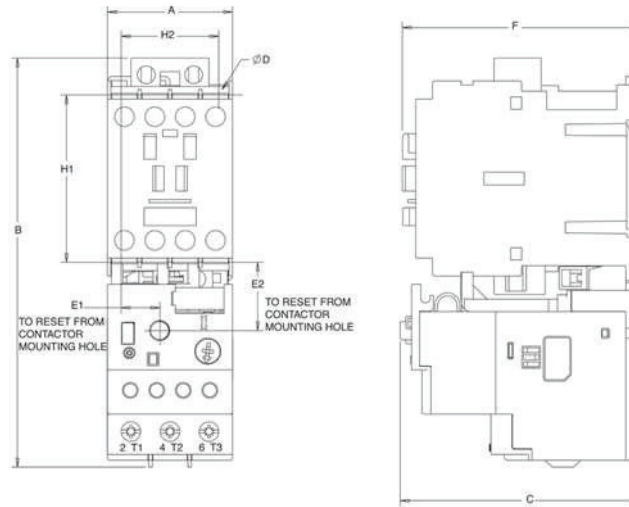

| Overload | Mounted to Contactor | A Width | B Height | C Depth | D | E1 | E2 | F | H1 | H2 | |
|---------------------------------------------------------------|----------------------|---------|----------|---------|-------|-----|------|------|-------|-----|----|
| CEP7-ED1ED..FD CEP7-ED1...B CEP7-EE...B CEP7S-EE...B | CA7-9...23 | mm | 45 | 146,6 | 85,2 | 4,5 | 13,9 | 24,5 | 86,5 | 60 | 35 |
| CEP7-ED1...D CEP7-EE...D CEP7S-EE...D | CA7-30...37 | mm | 45 | 146,6 | 101,2 | 4,5 | 13,9 | 24,5 | 104 | 60 | 35 |
| CEP7-ED1...D CEP7-EE...D CEP7S-EE...D | CA7-43 | mm | 54 | 146,6 | 101,2 | 4,5 | 18,9 | 24,5 | 107 | 60 | 45 |
| CEP7-EE...E CEP7S-EE...E | CA7-60...97 | mm | 72 | 192,3 | 120,4 | 5,4 | 23,8 | 29 | 125,5 | 100 | 55 |

Dimension Diagram

Connection / Wiring Diagram