



## Main

Range of product	Harmony XVB Universal
Product or component type	Base unit with cover
Component name	XVBC

## Complementary

Range compatibility	AS-Interface cabling system
Material	Polycarbonate on cover unit Glass reinforced polyamide on base unit
Mounting diameter	70 mm
[Us] rated supply voltage	24...31.6 V for AS-Interface line application 19.2...30 V for external application
Current consumption	30 mA (under load) external 250 mA (under load) via AS-Interface line 30 mA (no load)
AS-i profile	S.7.F
Electrical connection	1 connector M12 for AS-Interface line
Cable entry	Side entry
Assembly style	Customer assembly, up to 5 units
[Ui] rated insulation voltage	250 V conforming to IEC 60947-1
[Uimp] rated impulse withstand voltage	4 kV conforming to IEC 60947-1
Terminals description ISO n°1	(COM-1)PW (COM-2)PW (COM-3)PW (COM-4)PW (COM-5)PW (GND)GROUND
Product weight	0.19 kg

## Environment

Product certifications	AS-Interface No 25701 CSA
Standards	EN/IEC 60947-5-1
Protective treatment	TC
Ambient air temperature for storage	-20...70 °C
Ambient air temperature for operation	-10...50 °C
Shock resistance	25 gn conforming to IEC 60068-2-27
Vibration resistance	5 gn conforming to IEC 60068-2-6
Class of protection against electric shock	Class I conforming to IEC 60536
IP degree of protection	IP65 conforming to NF C 20-010 IP65 conforming to IEC 60529
NEMA degree of protection	NEMA 4X indoor conforming to UL 508

Indicator Bank without “Flash” Discharge Tube Unit

Dimensions

Below drawing shows the minimum configuration of the product. Select the number of stages according to the product characteristics in order to get b dimension.

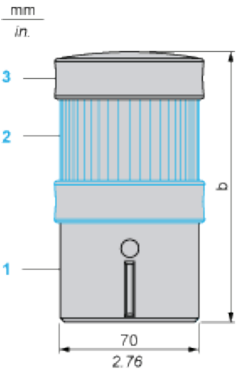

- (1) Base unit
- (2) Illuminated or audible signalling unit XVBC..., to be ordered separately
- (3) Cover (supplied with base unit)

Number of illuminated or audible signalling units (no “flash”)	b in mm	b in in.
1	138	5.43
2	201	7.91
3	264	10.39
4	327	12.87
5	390	15.35

---

Base Unit for Indicator Banks

---

Panel Cut-out for Direct Fixing

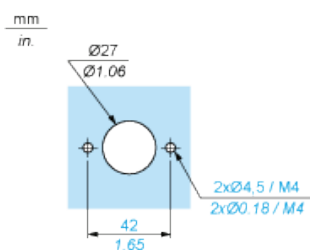

## Illuminated Beacon

### Wiring Diagram

