



# Hardware



## Copper Crimp Lugs Standard And Bellmouth Suit Flexible And Stranded Cables



Part No Standard	Nominal Conductor mm	ID Size	Stud	A	B	C	D	Part No Bell Mouth
CL70-6	70	11.2	6.0	54	21	3.3	24	CL70-6BM
CL70-8	70	11.2	8.0	54	21	3.3	24	CL70-8BM
CL70-10	70	11.2	10.0	54	21	3.3	24	CL70-10BM
CL70-12	70	11.2	12.0	54	21	3.3	24	CL70-12BM
CL95-8	95	13.4	8.0	60	25	3.9	26	CL95-8BM
CL95-10	95	13.4	10.0	60	25	3.9	26	CL95-10BM
CL95-12	95	13.4	12.0	60	25	3.9	26	CL95-12BM
CL95-16	95	13.4	16.0	6	28	3.4	30	CL95-16BM
CL120-10	120	15.6	10.0	64	29	5.0	26	CL120-10BM
CL120-12	120	15.6	12.0	64	29	5.0	26	CL120-12BM
CL120-16	120	15.6	16.0	68	29	5.0	26	CL120-16BM
CL150-10	150	16.7	10.0	71	32	5.5	32	CL150-10BM
CL150-12	150	16.7	12.0	80	32	5.5	41	CL150-12BM
CL150-16	150	16.7	16.0	80	32	5.5	41	CL150-16BM
CL185-10	185	18.4	10.0	74	35	5.7	32	CL185-10BM
CL185-12	185	18.4	12.0	83	35	5.7	41	CL185-12BM
CL185-16	185	18.4	16.0	83	35	5.7	41	CL185-16BM
CL240	240	21.2		92	40	7.1	42	CL240BM
CL240-12	240	21.2	12.0	92	40	7.1	42	CL240-12BM
CL300	300	23.5		101	45	7.8	46	CL300BM

For Crimping Tools See Page F5

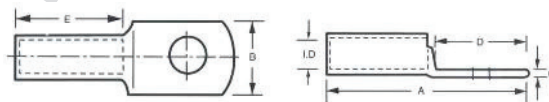

Subject To Variance And Manufacturing Tolerances