

# INDUSTRIAL SIRENS AND SOUNDERS

## Motor Sirens



### Super M

- Sound output 127dB @ 1m
- Continuous rating
- Weatherproof (when mounted with rotor end down)



#### Specifications:

Sound output: 127dB @ 1m (240V)  
 Sound frequency: 1600 Hz  
 Protection: IP55 (when mounted with rotor end down)  
 Rating: Continuous  
 Voltage tolerance: +10%  
 Temperature range (°C): -30 to +45  
 Cable Entry: Through base  
 Construction: ABS  
 Weight: 1.8Kg

Order Code	Voltage	Current
<b>SECXSM110</b>	110VAC/DC	2.7A
<b>SECXSM240</b>	240VAC/DC	1.0A

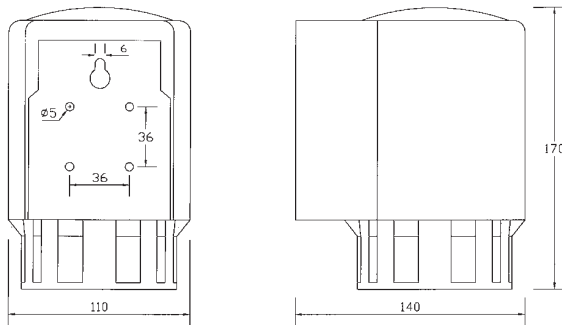

Dimensions in mm

### S04

- Sound output 125dB @ 1m
- Low penetrating tone
- Continuous rating
- Weatherproof
- Robust aluminium construction



#### Specifications:

Sound frequency: 900Hz  
 Protection: IP55  
 Rating: 20 min  
 Voltage tolerance: +10%  
 Temperature rating (°C): -30 to +45  
 Cable entry: 20 mm  
 Construction: Aluminium alloy  
 Weight: 4.5Kg

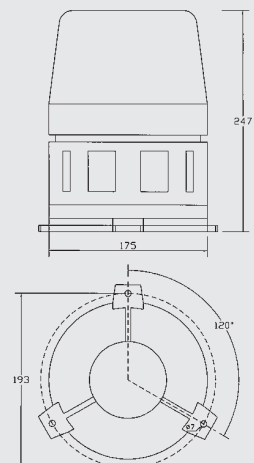

Dimensions in mm

Order Code	Voltage	Current	Sound Output
<b>SEC1304</b>	24VDC	8A	116dB @1m
<b>SEC1310</b>	110VAC/DC	3.7A	125dB @1m
<b>SEC1340</b>	240VAC/DC	2.1A	125dB @1m