

Data Sheet



LED Satellite Surface Mount – D50



CAT NO. 659013LI, 659014LI



659013LI

Specifications		
Cat No	659013LI	659014LI
Finish	White	Black
Battery pack	Li-ion 6.4V, 1.5Ah	
Operating Voltage	240V a.c. +/- 6% 50Hz	
Power Consumption	1.5W	
Body Constructions	Polycarbonate	
Operating Temperature	10° to 40°	
IP Rating	IP20	
Compliance	AS/NZS 2293 AS/NZS 60598  	



LED Satellite Surface Mount – D50



CAT NO. 659013LI, 659014LI

- Embedded Bluetooth for smart device connectivity
- Low Power Wide Area Network type of communications utilising the LoRa platform
- LoRa communication to maximise reliability, coverage and infiltration
- iSmart™ temperature sensing technology for the LIION battery
- Electronics designed to lengthen the life of the battery, minimising maintenance costs
- Environmentally friendly battery
- Easy to install
- One high Brightness LED
- 5 year warranty

Cat No	Description	Classification C ₀ /C ₉₀
659013LI	Galaxy LED Satellite Surface Mount White	D50
659014LI	Galaxy LED Satellite Surface Mount Black	D50

DIMENSIONS

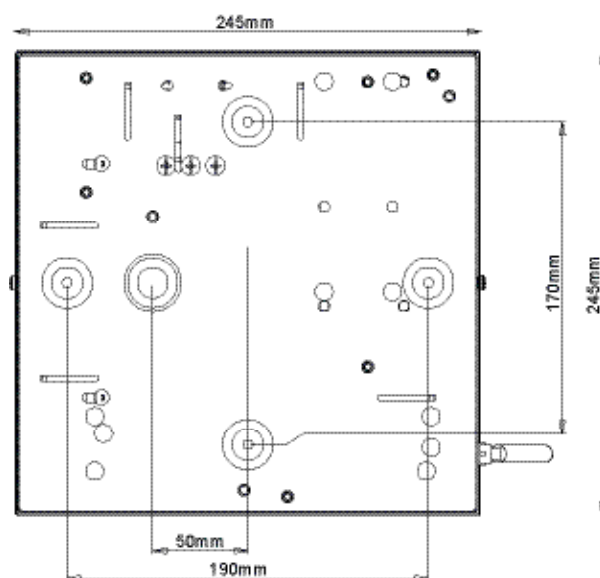

Spacing table:

Maximum spacings between luminaires for 0.2 lux (Australia)

Mounting Height (m)	2.4	2.7	3	3.3	3.6	4.0
A	18.7	19.4	20.1	20.7	21.2	21.8
B	18.7	19.4	20.1	20.7	21.2	21.8

Maximum spacings between luminaires for 1 lux (New Zealand)

Mounting Height (m)	2.4	2.7	3	3.3	3.6	4.0
A	10.5	10.8	11	11.2	11.3	11.4
B	10.5	10.8	11	11.2	11.3	11.4

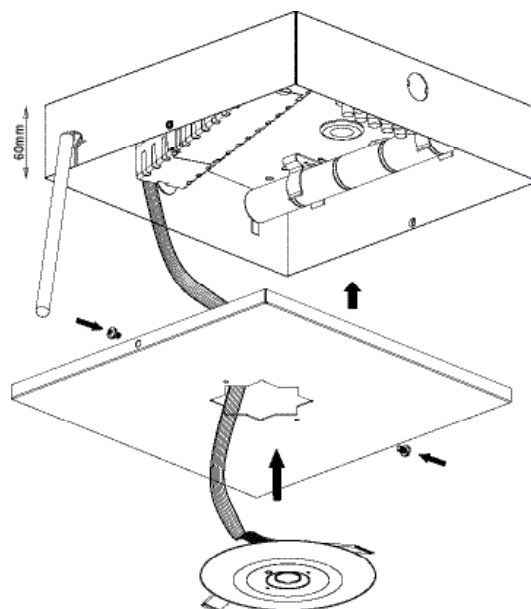
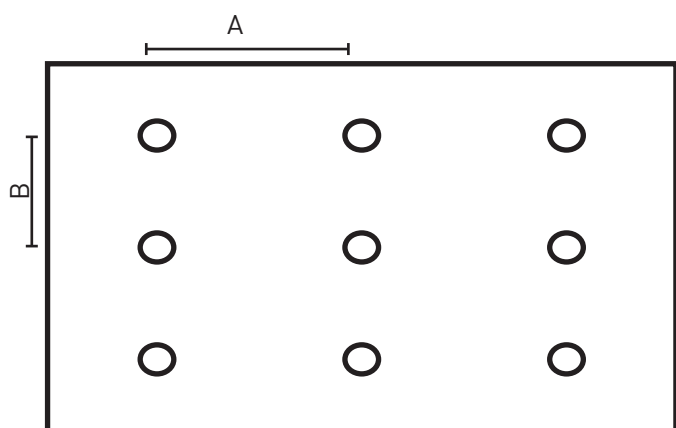

Legrand - Australia
1300 369 777
www.legrand.com.au
ABN 31 000 102 661

Legrand - New Zealand
0800 476 009
www.legrand.co.nz

Refer to your group buying office, Legrand Sales Representative or Legrand Sales Office for pricing.

Please note: specifications are subject to change without prior notice.