

PRODUCT DETAILS

Nema 1 cable ladder is manufactured from strip steel to the following Standards:

- Mild steel and Hot Dip Galvanised to AS/NZS1365, AS1594, AS/NZS4680, ISO1461
- Stainless Steel to AS1449/AS2837

STANDARD LENGTH

- 3 metres
- 6 metres (manufactured against firm orders only.)

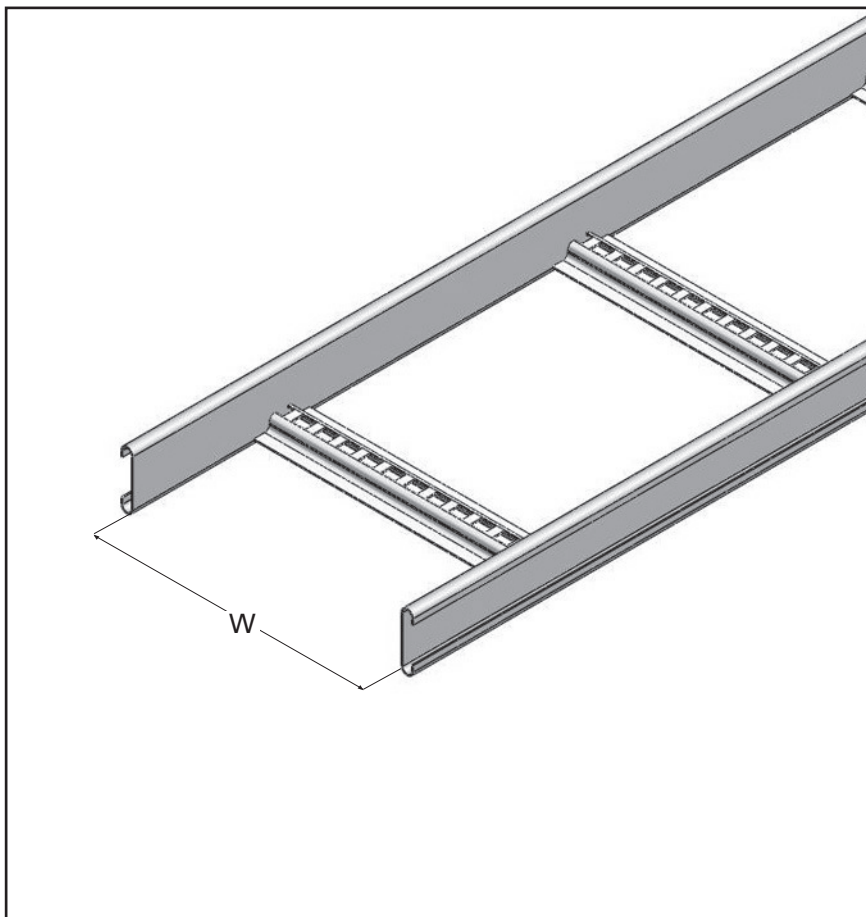

NEMA 1 LADDER

ORDERING DETAILS

Sold per length

Available finish –

- H** - Hot dip galvanised
- S** - Stainless Steel

Stainless Steel products are manufactured against firm orders only.

Minimum production quantities may apply.

Ordering Code	Cable Laying Width (W) mm	Cable Laying Depth mm	Overall Width mm	Side Rail Height mm
N1 L 150 _	150	43	176	65
N1 L 300 _	300	43	326	65
N1 L 450 _	450	43	476	65
N1 L 600 _	600	43	626	65
N1 L 900 _	900	43	926	65

↑ H - Hot Dip Galvanised
 — S - Stainless Steel

LOAD RATING AND DEFLECTION

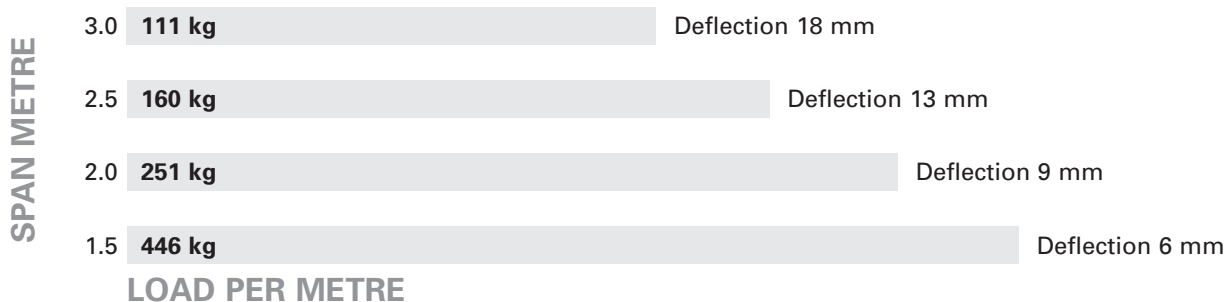

Nema 1 Cable Ladder has been tested in accordance with NEMA standards and the load ratings certified by a NATA accredited testing facility.

A guide to deflection for continuous runs has been included for easy reference, however it should be noted that the positioning of splice joints and loading techniques can significantly impact upon the actual deflection. Refer to NEMA VE2 Installation guidelines for further explanation.

ORDERING DETAILS

A simple guide to step by step ordering has been outlined to assist you in understanding the EzyStrut code language. You will find the guide most informative, using self explanatory logic which will enable you to easily apply the principals when placing an order.

Example for Nema1 External Riser 300 wide, 300 radius, Hot Dip Galvanised

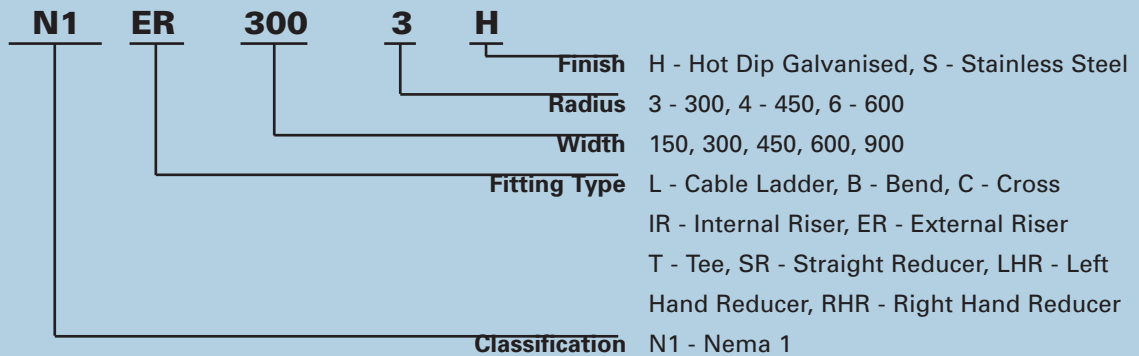

- M8 HEX screws (HS820H) should be ordered separately for installation.
- Non standard radius Hot Dip Galvanised fittings are manufactured against firm orders only.
- Stainless Steel fittings are manufactured against firm orders only.

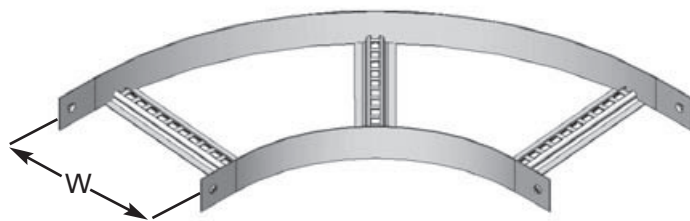

Fitting shown for illustration purposes only. The rung layout shown is typical and will vary on each fitting, depending on width and radius.

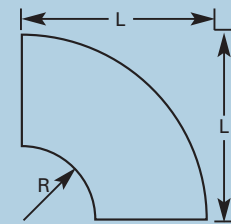

Length does not include built in splice plates.
Splice plate length 75mm

CABLE LADDER BEND

Ordering Code	Width (W)	Length (L) mm	Radius (R)
N1 B 150 3 _	150	450	300
N1 B 300 3 _	300	600	300
N1 B 450 3 _	450	750	300
N1 B 600 3 _	600	900	300
N1 B 900 3 _	900	1200	300

Insert last digit of ordering code as follows:
H - Hot Dip Galvanised
S - Stainless Steel

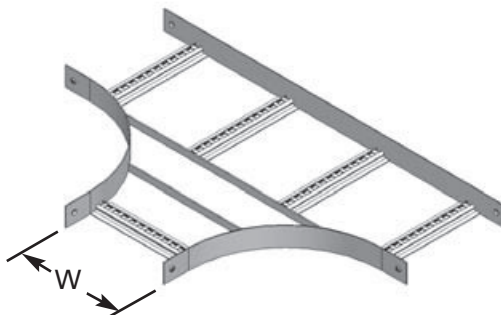

Fitting shown for illustration purposes only. The rung layout shown is typical and will vary on each fitting, depending on width and radius.

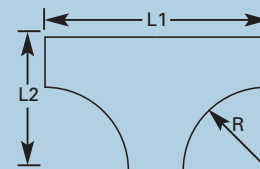

Length does not include built in splice plates.
Splice plate length 75mm

CABLE LADDER TEE

Ordering Code	Width (W)	Length (L1) mm	Length (L2)mm	Radius (R)
N1 T 150 3 _	150	750	450	300
N1 T 300 3 _	300	900	600	300
N1 T 450 3 _	450	1050	750	300
N1 T 600 3 _	600	1200	900	300
N1 T 900 3 _	900	1500	1200	300

Insert last digit of ordering code as follows:
H - Hot Dip Galvanised
S - Stainless Steel

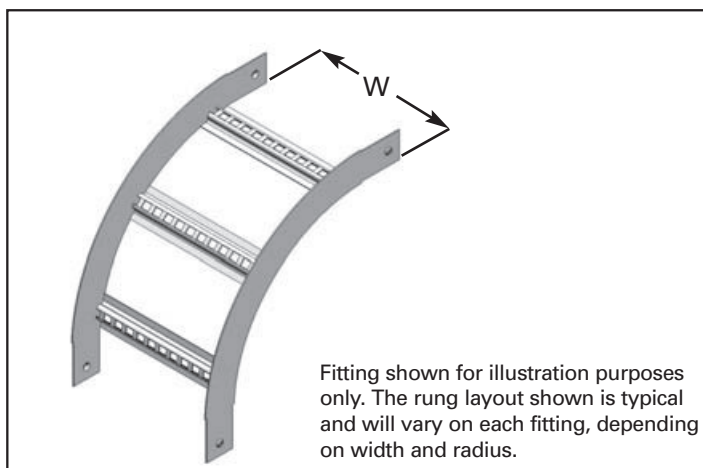

CABLE LADDER EXTERNAL RISER

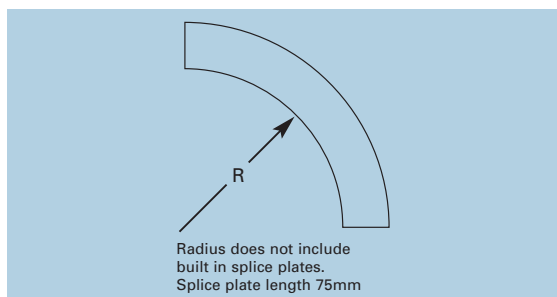

Ordering Code	Width (W)	Radius (R)
N1 ER 150 3 _	150	300
N1 ER 300 3 _	300	300
N1 ER 450 3 _	450	300
N1 ER 600 3 _	600	300
N1 ER 900 3 _	900	300

Insert last digit of ordering code as follows:

H - Hot Dip Galvanised
S - Stainless Steel

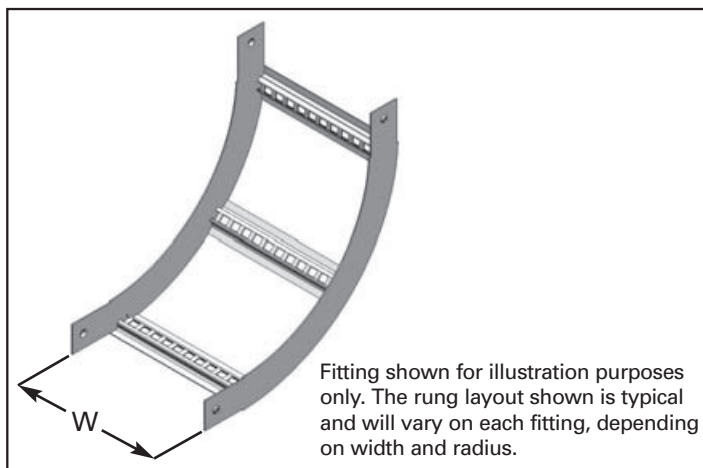

CABLE LADDER INTERNAL RISER

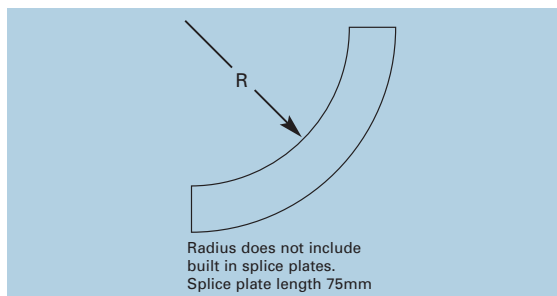

Ordering Code	Width (W)	Radius (R)
N1 IR 150 3 _	150	300
N1 IR 300 3 _	300	300
N1 IR 450 3 _	450	300
N1 IR 600 3 _	600	300
N1 IR 900 3 _	900	300

Insert last digit of ordering code as follows:

H - Hot Dip Galvanised
S - Stainless Steel

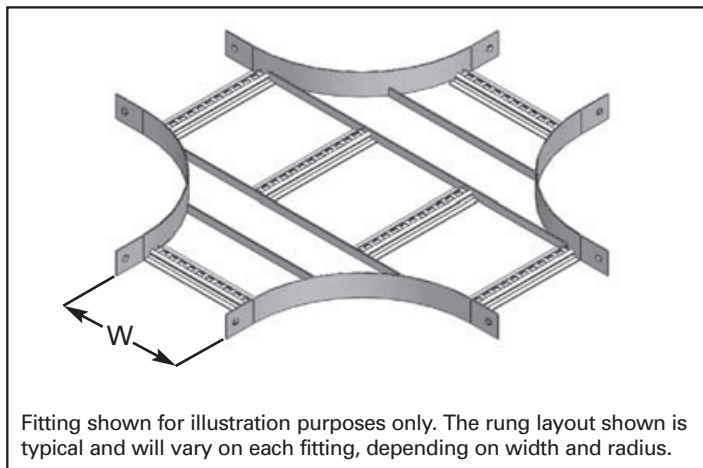

CABLE LADDER CROSS

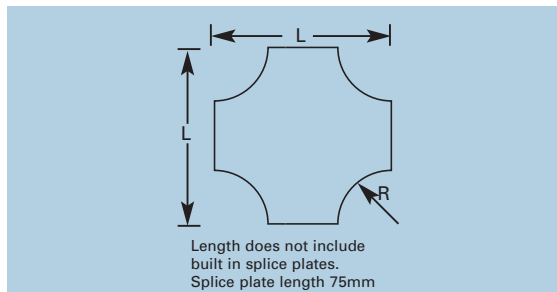

Ordering Code	Width (W)mm	Length (L)mm	Radius (R)mm
N1 C 150 3 _	150	750	300
N1 C 300 3 _	300	900	300
N1 C 450 3 _	450	1050	300
N1 C 600 3 _	600	1200	300
N1 C 900 3 _	900	1500	300

Insert last digit of ordering code as follows:

H - Hot Dip Galvanised
S - Stainless Steel

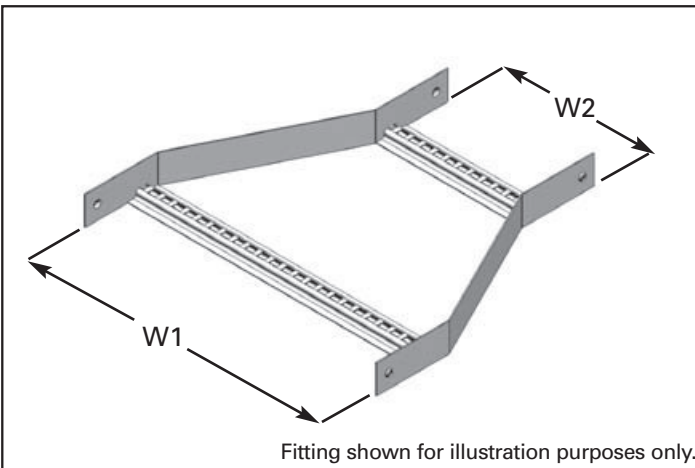

CABLE LADDER STRAIGHT REDUCER

Insert last digit of ordering code as follows:
H - Hot Dip Galvanised
S - Stainless Steel

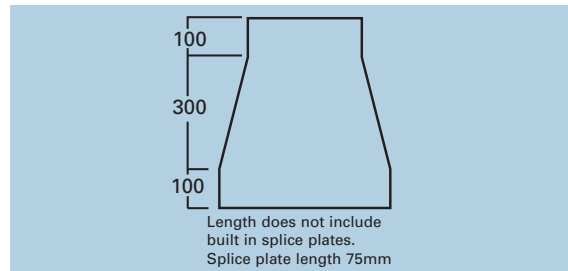

Ordering Code	Width 1 (W1)	Width 2 (W2)
N1 SR 900 600 _	900	600
N1 SR 900 450 _	900	450
N1 SR 900 300 _	900	300
N1 SR 900 150 _	900	150
N1 SR 600 450 _	600	450
N1 SR 600 300 _	600	300
N1 SR 600 150 _	600	150
N1 SR 450 300 _	450	300
N1 SR 450 150 _	450	150
N1 SR 300 150 _	300	150

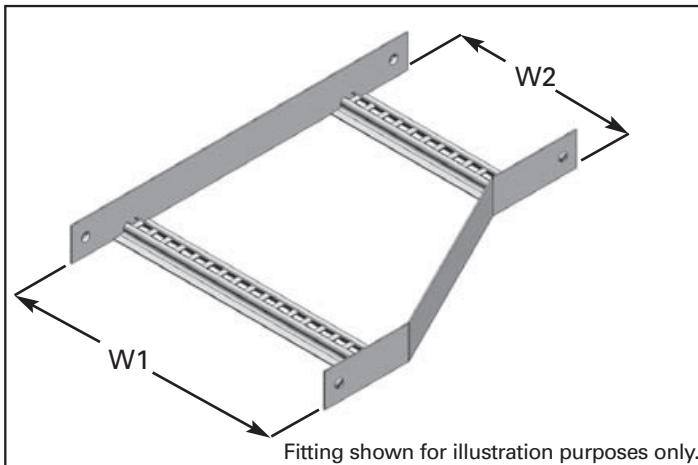

CABLE LADDER LEFT HAND REDUCER

Insert last digit of ordering code as follows:
H - Hot Dip Galvanised
S - Stainless Steel

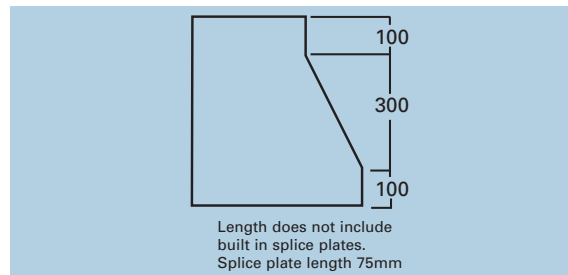

Ordering Code	Width 1 (W1)	Width 2 (W2)
N1 LHR 900 600 _	900	600
N1 LHR 900 450 _	900	450
N1 LHR 900 300 _	900	300
N1 LHR 900 150 _	900	150
N1 LHR 600 450 _	600	450
N1 LHR 600 300 _	600	300
N1 LHR 600 150 _	600	150
N1 LHR 450 300 _	450	300
N1 LHR 450 150 _	450	150
N1 LHR 300 150 _	300	150

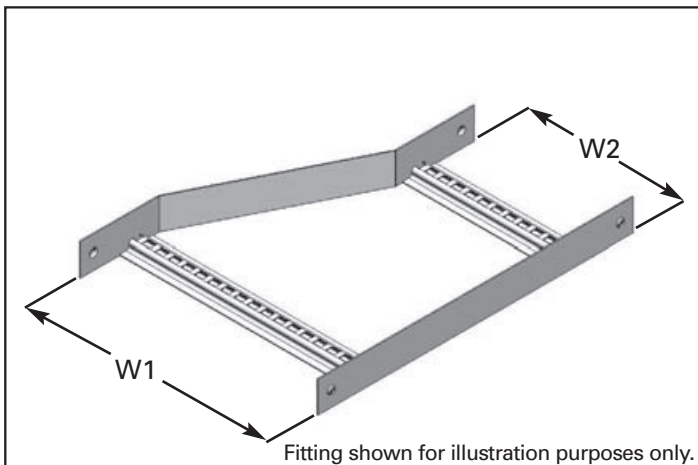

CABLE LADDER RIGHT HAND REDUCER

Insert last digit of ordering code as follows:
H - Hot Dip Galvanised
S - Stainless Steel

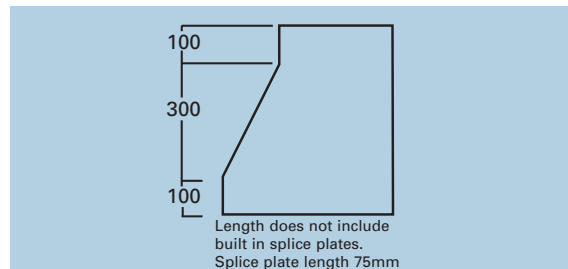

Ordering Code	Width 1 (W1)	Width 2 (W2)
N1 RHR 900 600 _	900	600
N1 RHR 900 450 _	900	450
N1 RHR 900 300 _	900	300
N1 RHR 900 150 _	900	150
N1 RHR 600 450 _	600	450
N1 RHR 600 300 _	600	300
N1 RHR 600 150 _	600	150
N1 RHR 450 300 _	450	300
N1 RHR 450 150 _	450	150
N1 RHR 300 150 _	300	150

PRODUCT DETAILS

EzyStrut cable ladder splices are manufactured from sheet steel to the following AS Standards:

- Mild Steel to AS/NZS1365 and Hot Dip Galvanised to AS/NZS4680, ISO1461
- Stainless Steel to AS1449, AS1837

ORDERING DETAILS

Available finish:

- H** - Hot Dip Galvanised
- S** - Stainless Steel

Stainless Steel products are manufactured against firm orders only. Minimum quantities may apply.

2 Splices required per length of cable ladder.
Order fasteners separately for installation.
• 2 x HS820H (per splice plate)

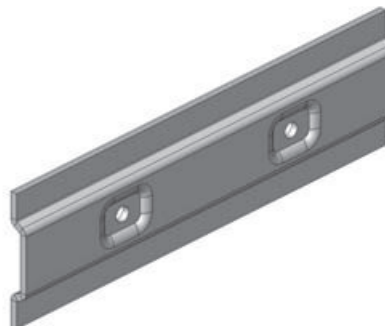

Ordering Code	To suit	Weight
N1 S _	Nema 1	0.28

SPLICE PLATE

2 Vertical Splices required per length of cable ladder.
Order fasteners separately for installation.
• 2 x HS820H (per splice plate)

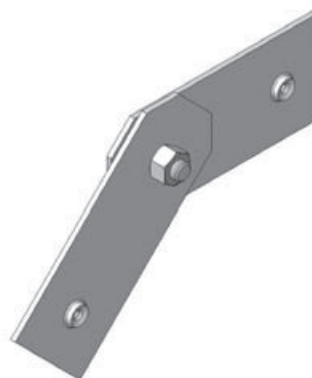

Ordering Code	To suit	Weight
N1 VS _	Nema 1	0.39

VERTICAL SPLICE PLATE

2 Horizontal Splices required per length of cable ladder.
Order fasteners separately for installation.
• 2 x HS820H (per splice plate)

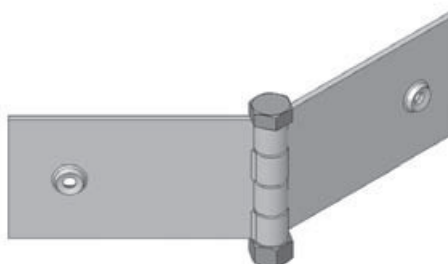

Ordering Code	To suit	Weight
N1 HS _	Nema 1	0.38

HORIZONTAL SPLICE PLATE

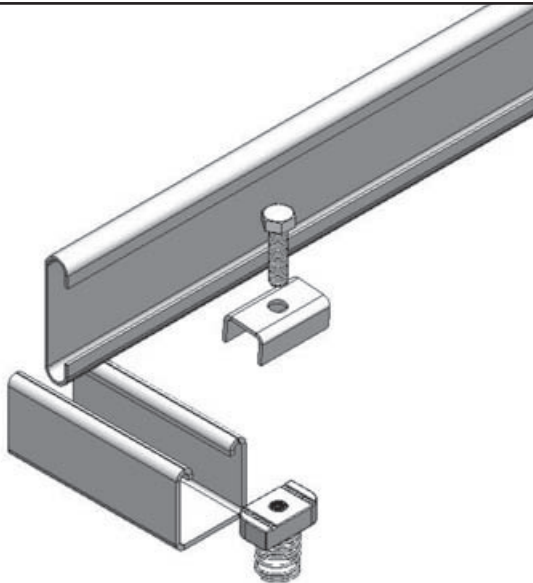

Supplied complete with hold down plate, spring nut and screw.
Hold down units are supplied with zinc plated fasteners as standard.

Ordering Code	To suit	Weight
N1 HDU _	Nema 1	0.07

H - Hot Dip Galvanised
 Z - Zinc Plated
 S - Stainless Steel

HOLD DOWN UNIT

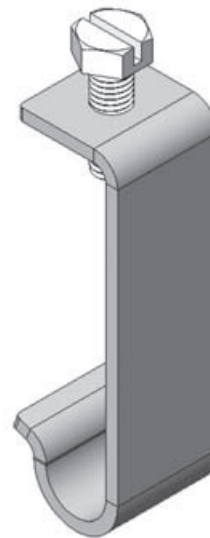

Supplied complete with cone screw for installation.
Suitable for use on both cable ladders and fittings.

Ordering Code	To suit	Weight
N1 CC _	Nema 1	0.09

H - Hot Dip Galvanised
 S - Stainless Steel

COVER CLAMP

Hot Dip Galvanised Divider Strip is available to firm client orders, however we advise against the process on sheet metal products as product distortion is likely to occur as a result.

Ordering Code	To suit	Weight
N1 DS _	Nema 1	1.00

G - Galvanised
 H - Hot Dip Galvanised
 S - Stainless Steel

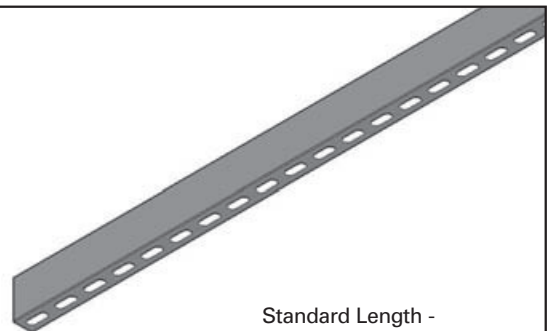

Standard Length - 2.4 metres
 Standard finish - Pre Galvanised (Galvabond)

DIVIDER STRIP

PRODUCT DETAILS

Nema 2 cable ladder is manufactured from strip steel to the following Standards:

- Mild steel and Hot Dip Galvanised to AS/NZS1365, AS1594, AS/NZS4680, ISO1461
- Stainless Steel to AS1449/AS2837

STANDARD LENGTH

- metres
- 3 metres (manufactured against firm orders only.)

Meets the loading requirements of Nema 16A classification

Fire Rated to AS/NZS 3013:1995

Consult your local Sales Office for specific loading capacities and installation techniques that must be followed in order to comply with the AS/NZS3013 standard.

ORDERING DETAILS

Sold per length

Available finish:

H – Hot dip galvanised

S – Stainless Steel

Stainless Steel products are manufactured against firm orders only. Minimum production quantities may apply.

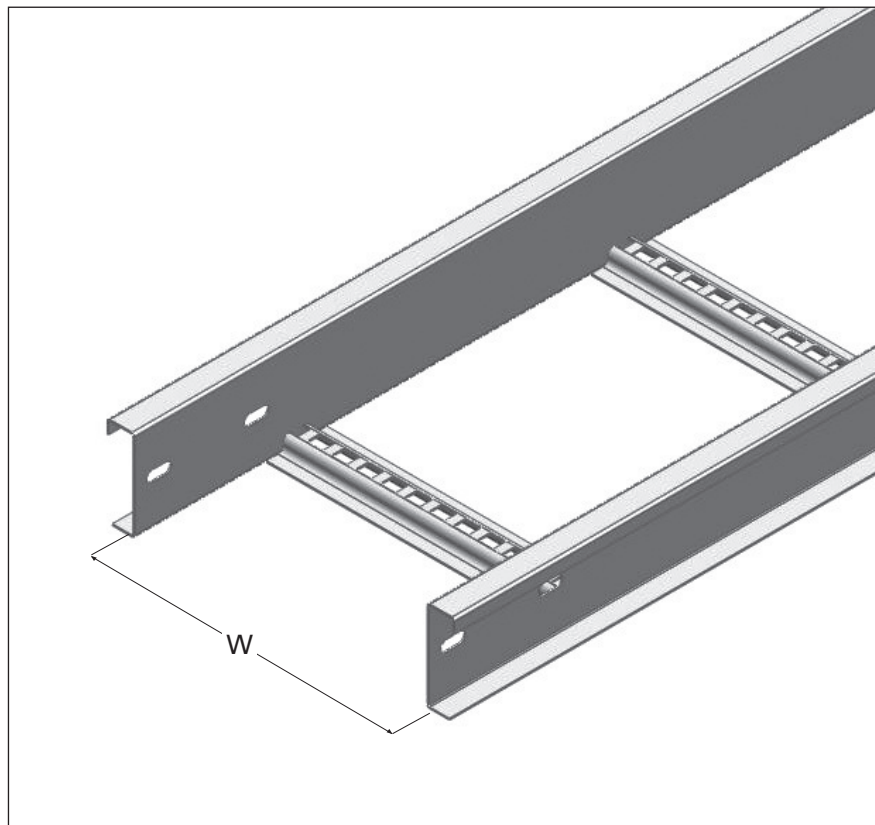

NEMA 2 LADDER

Ordering Code	Cable Laying Width (W) mm	Cable Laying Depth mm	Overall Width mm	Side Rail Height mm
N2L150	150	75	206	93
N2L300	300	75	356	93
N2L450	450	75	506	93
N2L600	600	75	656	93
N2L900	900	75	956	93

↑
H – Hot Dip Galvanised
S – Stainless Steel

LOAD RATING AND DEFLECTION

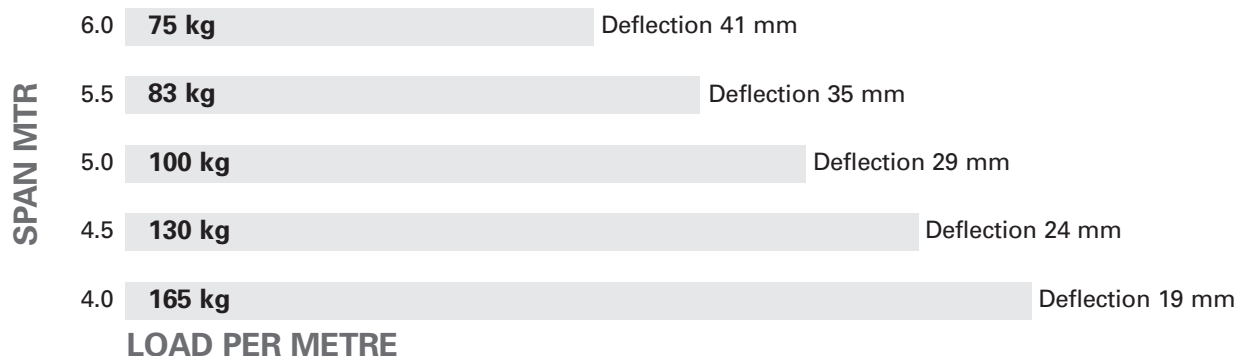

Nema 2 Cable Ladder has been tested in accordance with NEMA standards and the load ratings certified by a NATA accredited testing facility.

A guide to deflection for continuous runs has been included for easy reference, however it should be noted that the positioning of splice joints and loading techniques can significantly impact upon the actual deflection. Refer to NEMA VE2 Installation guidelines for further explanation.

PRODUCT DETAILS

Nema 3 cable ladder is manufactured from strip steel to the following Standards:

- Mild steel and Hot Dip Galvanised to AS/NZS1365, AS1594, AS/NZS4680, ISO1461
- Stainless Steel to AS1449/AS2837

STANDARD LENGTH

- 6 metres
- 3 metres (manufactured against firm orders only.)

Meets the loading requirements of Nema 20B classification

Fire Rated to AS/NZS 3013:1995*

Consult your local Sales Office for specific loading capacities and installation techniques that must be followed in order to comply with the AS/NZS3013 standard.

ORDERING DETAILS

Sold per length

Available finish

H – Hot dip galvanised

S – Stainless Steel

Stainless Steel products are manufactured against firm orders only.

Minimum production quantities may apply.

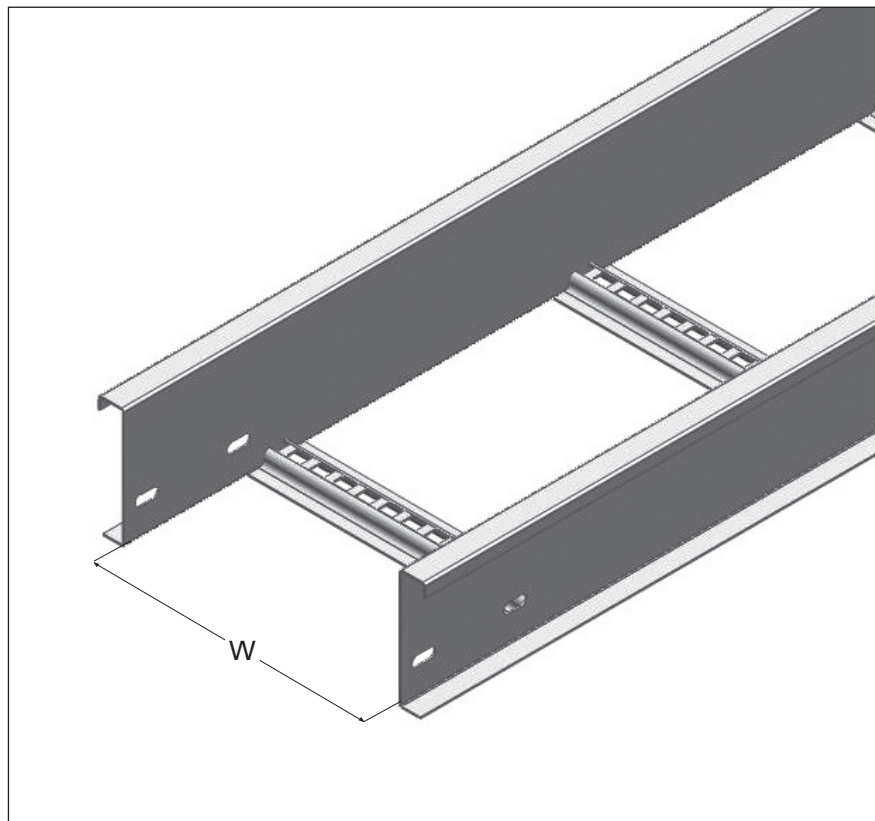

NEMA 3 LADDER

Ordering Code	Cable Laying Width (W) mm	Cable Laying Depth mm	Overall Width mm	Side Rail Height mm
N3L150	150	115	206	130
N3L300	300	115	356	130
N3L450	450	115	506	130
N3L600	600	115	656	130
N3L900	900	115	956	130

↑
H – Hot Dip Galvanised
S – Stainless Steel

LOAD RATING AND DEFLECTION

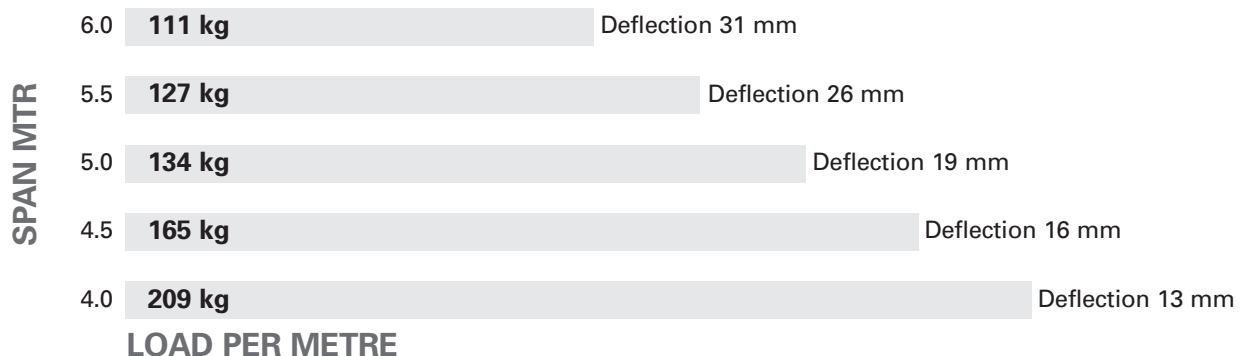

Nema 3 Cable Ladder has been tested in accordance with NEMA standards and the load ratings certified by a NATA accredited testing facility.

A guide to deflection for continuous runs has been included for easy reference, however it should be noted that the positioning of splice joints and loading techniques can significantly impact upon the actual deflection. Refer to NEMA VE2 Installation guidelines for further explanation.

PRODUCT DETAILS

The standard radius for each cable ladder classification is noted

- Nema 2, 450 radius*
- Nema 3, 450 radius

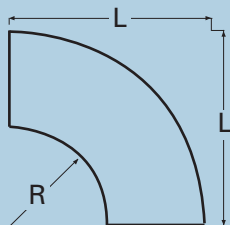

Length does not include built in splice plates. Splice plate length 150mm.

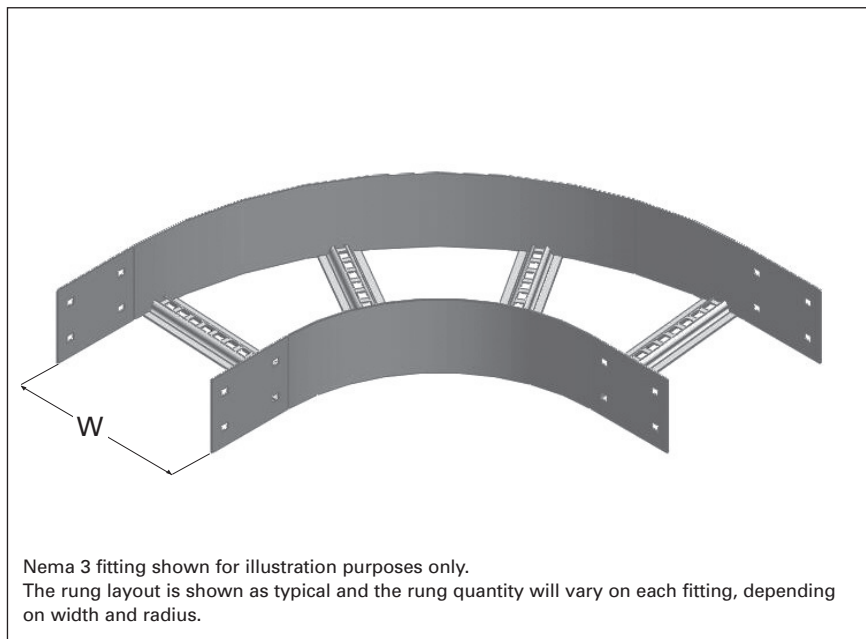

Nema 3 fitting shown for illustration purposes only.

The rung layout is shown as typical and the rung quantity will vary on each fitting, depending on width and radius.

CABLE LADDER BEND

ORDERING DETAILS

Example for Nema 2 Bend 450 wide, 450 radius, Hot Dip Galvanised

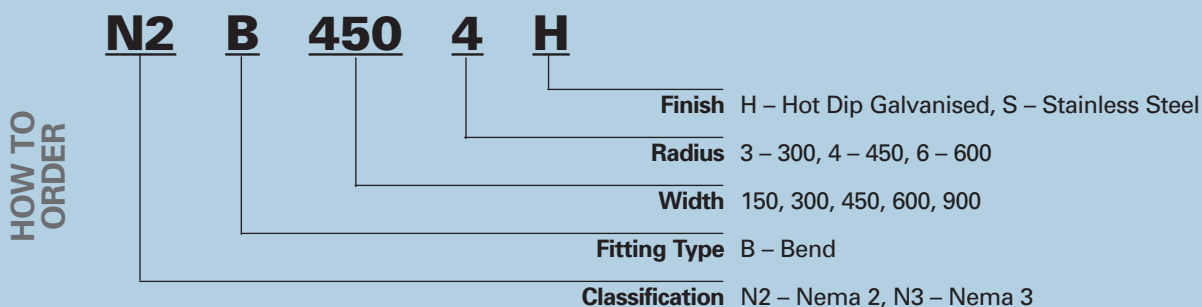

- 8 splice bolts (SBH or SBS) and splice nuts (SNH or SNS) should be ordered separately for installation.
- Non standard radius Hot Dip Galvanised fittings are manufactured against firm orders only.
- Stainless Steel fittings are manufactured against firm orders only.

	Ordering Code	Cable laying Width mm	Cable laying depth		Length (L) mm
			Nema 2	Nema 3	
300 Radius	B1503	150	75	112	450
	B3003	300	75	112	600
	B4503	450	75	112	750
	B6003	600	75	112	900
	B9003	900	75	112	1200
450* Radius standard	B1504	150	75	112	600
	B3004	300	75	112	750
	B4504	450	75	112	900
	B6004	600	75	112	1050
	B9004	900	75	112	1350
600 Radius	B1506	150	75	112	750
	B3006	300	75	112	900
	B4506	450	75	112	1050
	B6006	600	75	112	1200
	B9006	900	75	112	1500

N2 – Nema 2
N3 – Nema 3

H – Hot Dip Galvanised
S – Stainless Steel

PRODUCT DETAILS

The standard radius for each cable ladder classification is noted

- Nema 2, 450 radius*
- Nema 3, 450 radius

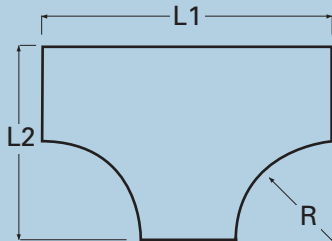

Length does not include built in splice plates. Splice plate length 150mm.

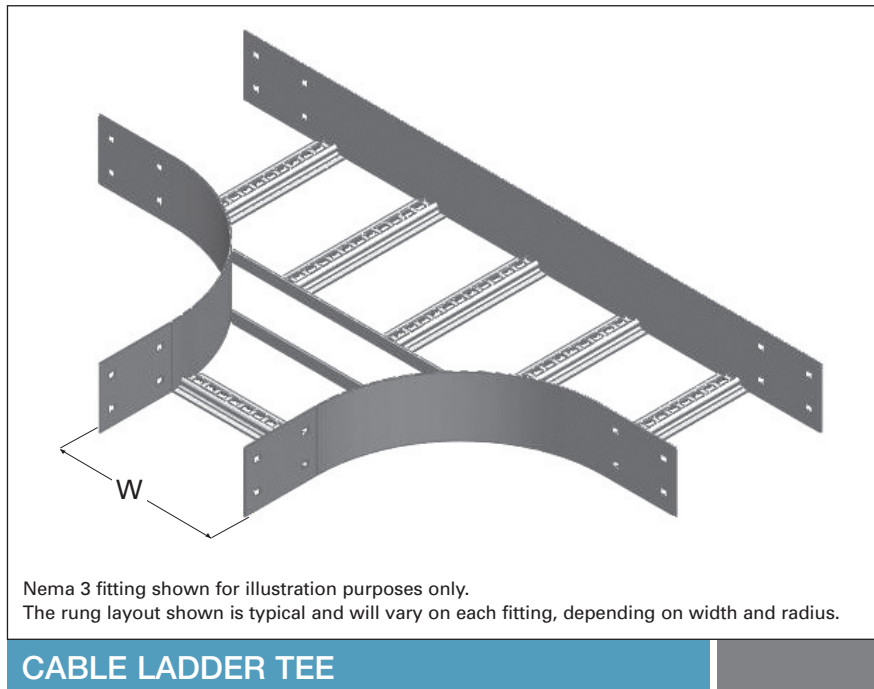

Nema 3 fitting shown for illustration purposes only.

The rung layout shown is typical and will vary on each fitting, depending on width and radius.

CABLE LADDER TEE

ORDERING DETAILS

Example for Nema 3 Tee 150 wide, 450 radius, Hot Dip Galvanised

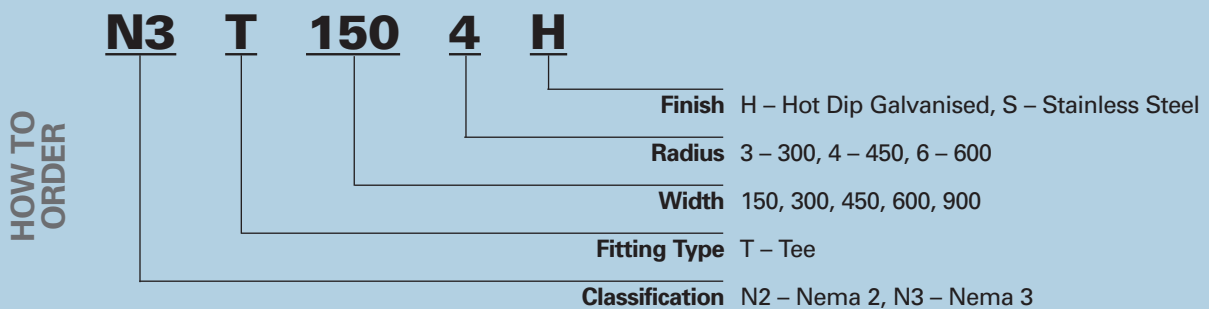

- 12 splice bolts (SBH or SBS) and splice nuts (SNH or SNS) should be ordered separately for installation.
- Non standard radius Hot Dip Galvanised fittings are manufactured against firm orders only.
- Stainless Steel fittings are manufactured against firm orders only.

	Ordering Code	Cable laying Width mm	Cable laying depth		Length 1 (L1) mm	Length 2 (L2) mm
			Nema 2	Nema 3		
300 Radius	T1503	150	75	112	750	450
	T3003	300	75	112	900	600
	T4503	450	75	112	1050	750
	T6003	600	75	112	1200	900
	T9003	900	75	112	1500	1200
450* Radius standard	T1504	150	75	112	1050	600
	T3004	300	75	112	1200	750
	T4504	450	75	112	1350	900
	T6004	600	75	112	1500	1050
	T9004	900	75	112	1800	1350
600 Radius	T1506	150	75	112	1350	750
	T3006	300	75	112	1500	900
	T4506	450	75	112	1650	1050
	T6006	600	75	112	1800	1200
	T9006	900	75	112	2100	1500

N2 – Nema 2
N3 – Nema 3

H – Hot Dip Galvanised
S – Stainless Steel

PRODUCT DETAILS

The standard radius for each cable ladder classification is noted

- Nema 2, 450 radius*
- Nema 3, 450 radius

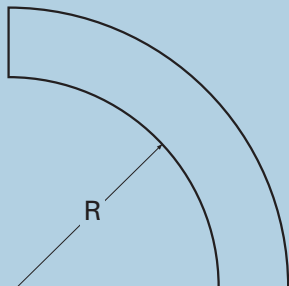

Radius does not include built in splice plates.
Splice plate length 150mm.

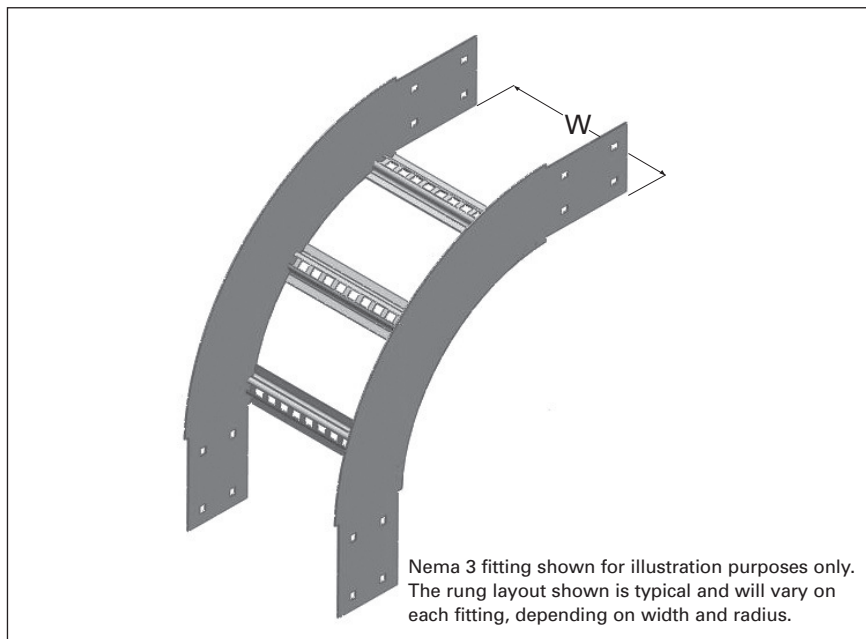

Nema 3 fitting shown for illustration purposes only.
The rung layout shown is typical and will vary on each fitting, depending on width and radius.

CABLE LADDER EXTERNAL RISER

ORDERING DETAILS

Example for Nema 2 External Riser 300 wide, 300 radius, Hot Dip Galvanised

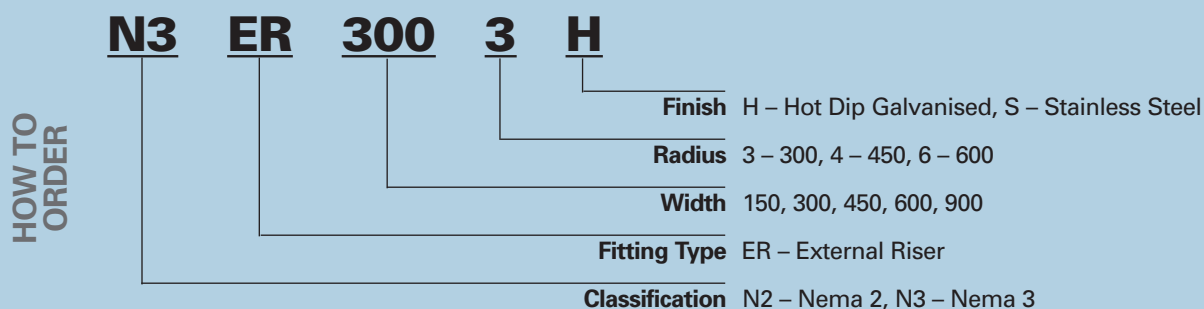

- 8 splice bolts (SBH or SBS) and splice nuts (SNH or SNS) should be ordered separately for installation.
- Non standard radius Hot Dip Galvanised fittings are manufactured against firm orders only.
- Stainless Steel fittings are manufactured against firm orders only.

	Ordering Code	Cable laying Width mm	Cable laying depth	
			Nema 2	Nema 3
300 Radius	ER1503	150	75	112
	ER3003	300	75	112
	ER4503	450	75	112
	ER6003	600	75	112
	ER9003	900	75	112
450* Radius standard	ER1504	150	75	112
	ER3004	300	75	112
	ER4504	450	75	112
	ER6004	600	75	112
	ER9004	900	75	112
600 Radius	ER1506	150	75	112
	ER3006	300	75	112
	ER4506	450	75	112
	ER6006	600	75	112
	ER9006	900	75	112

N2 – Nema 2
N3 – Nema 3

H – Hot Dip Galvanised
S – Stainless Steel

PRODUCT DETAILS

The standard radius for each cable ladder classification is noted

- Nema 2, 450 radius*
- Nema 3, 450 radius

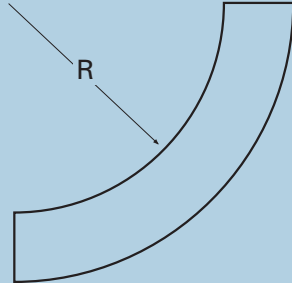

Radius does not include built in splice plates.
Splice plate length 150mm.

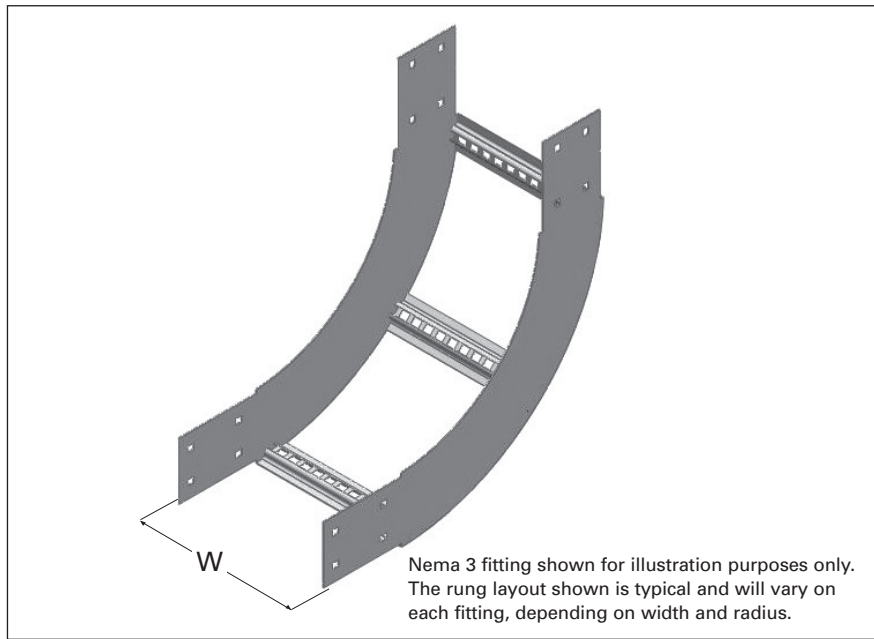

Nema 3 fitting shown for illustration purposes only.
The rung layout shown is typical and will vary on each fitting, depending on width and radius.

CABLE LADDER INTERNAL RISER

ORDERING DETAILS

Example for Nema 2 Internal Riser 450 wide, 300 radius, Hot Dip Galvanised

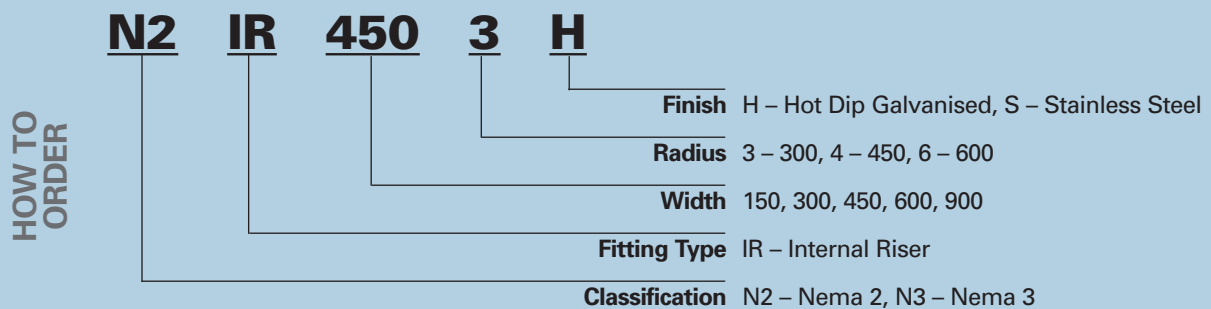

- 8 splice bolts (SBH or SBS) and splice nuts (SNH or SNS) should be ordered separately for installation.
- Non standard radius Hot Dip Galvanised fittings are manufactured against firm orders only.
- Stainless Steel fittings are manufactured against firm orders only.

	Ordering Code	Cable laying Width mm	Cable laying depth	
			Nema 2	Nema 3
300 Radius	IR1503	150	75	112
	IR3003	300	75	112
	IR4503	450	75	112
	IR6003	600	75	112
	IR9003	900	75	112
450* Radius standard	IR1504	150	75	112
	IR3004	300	75	112
	IR4504	450	75	112
	IR6004	600	75	112
	IR9004	900	75	112
600 Radius	IR1506	150	75	112
	IR3006	300	75	112
	IR4506	450	75	112
	IR6006	600	75	112
	IR9006	900	75	112

N2 – Nema 2
N3 – Nema 3

H – Hot Dip Galvanised
S – Stainless Steel

PRODUCT DETAILS

The standard radius for each cable ladder classification is noted

- Nema 2, 450 radius*
- Nema 3, 450 radius

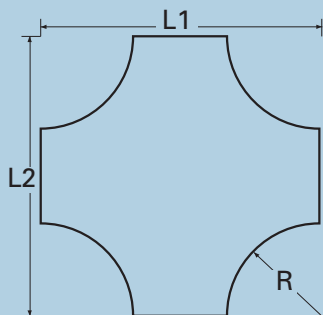

Length does not include built in splice plates.
Splice plate length 150mm.

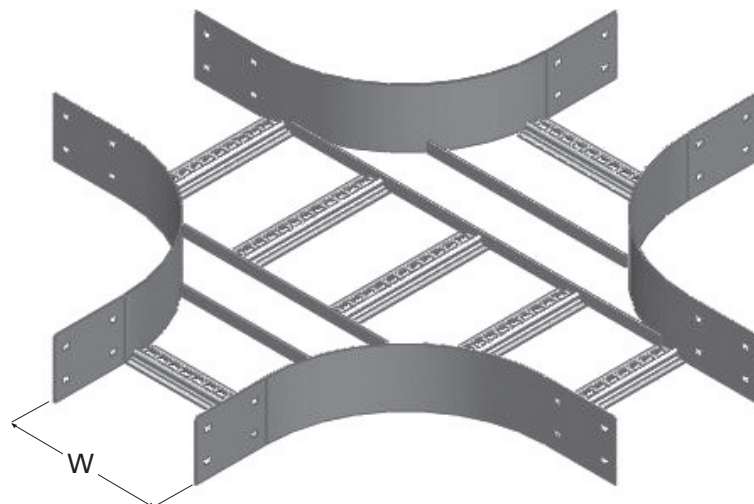

Nema 3 fitting shown for illustration purposes only.
The rung layout shown is typical and will vary on each fitting, depending on width and radius.

CABLE LADDER CROSS

ORDERING DETAILS

Example for Nema 2 Cross 600 wide, 450 radius, Hot Dip Galvanised

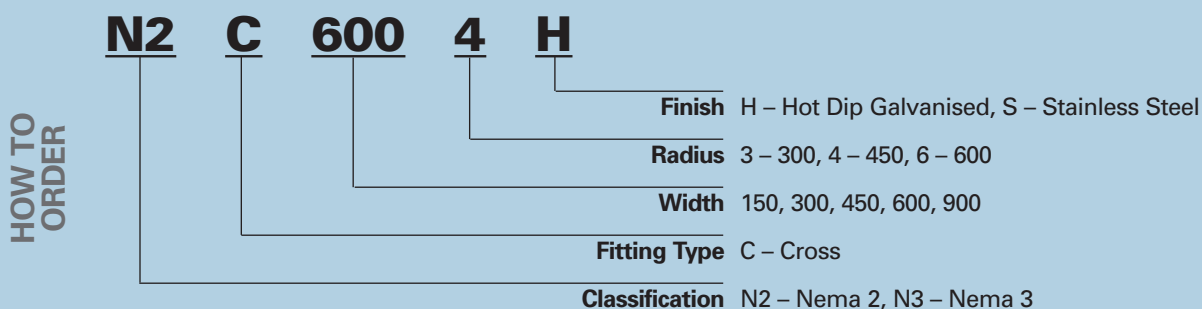

- 16 splice bolts (SBH or SBS) and splice nuts (SNH or SNS) should be ordered separately for installation.
- Non standard radius Hot Dip Galvanised fittings are manufactured against firm orders only.
- Stainless Steel fittings are manufactured against firm orders only.

	Ordering Code	Cable laying Width mm	Cable laying depth		Length 1 (L1) mm	Length 2 (L2) mm
			Nema 2	Nema 3		
300 Radius	C1503	150	75	112	750	750
	C3003	300	75	112	900	900
	C4503	450	75	112	1050	1050
	C6003	600	75	112	1200	1200
	C9003	900	75	112	1500	1500
450* Radius standard	C1504	150	75	112	1050	1050
	C3004	300	75	112	1200	1200
	C4504	450	75	112	1350	1350
	C6004	600	75	112	1500	1500
	C9004	900	75	112	1800	1800
600 Radius	C1506	150	75	112	1350	1350
	C3006	300	75	112	1500	1500
	C4506	450	75	112	1650	1650
	C6006	600	75	112	1800	1800
	C9006	900	75	112	2100	2100

N2 - Nema 2
N3 - Nema 3
H - Hot Dip Galvanised
S - Stainless Steel

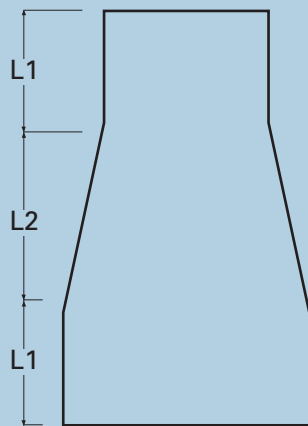

Length does not include built in splice plates.
Splice plate length 150mm.

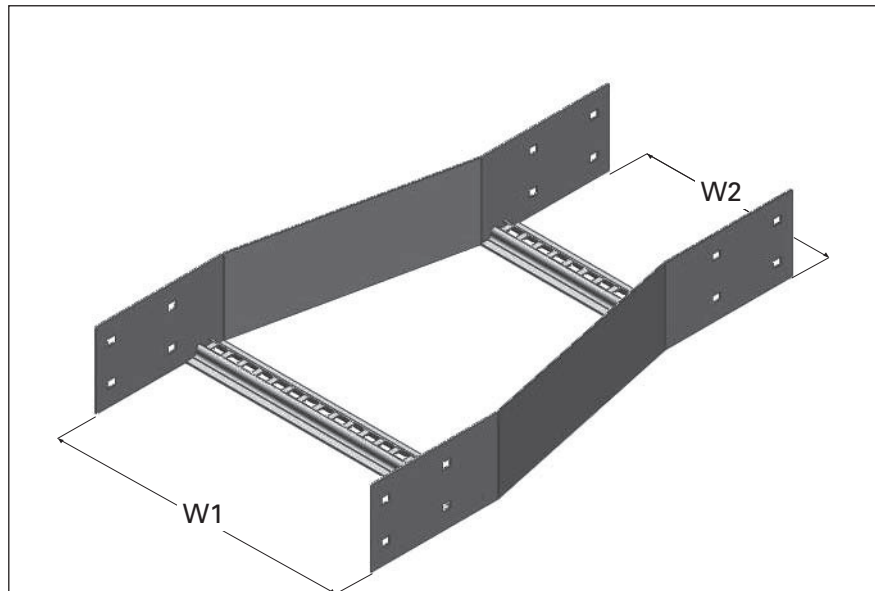

Nema 3 fitting shown for illustration purposes only.

CABLE LADDER STRAIGHT REDUCER

ORDERING DETAILS

Example for Nema 2 Straight Reducer 900 wide, reducing to 300 wide, Hot Dip Galvanised

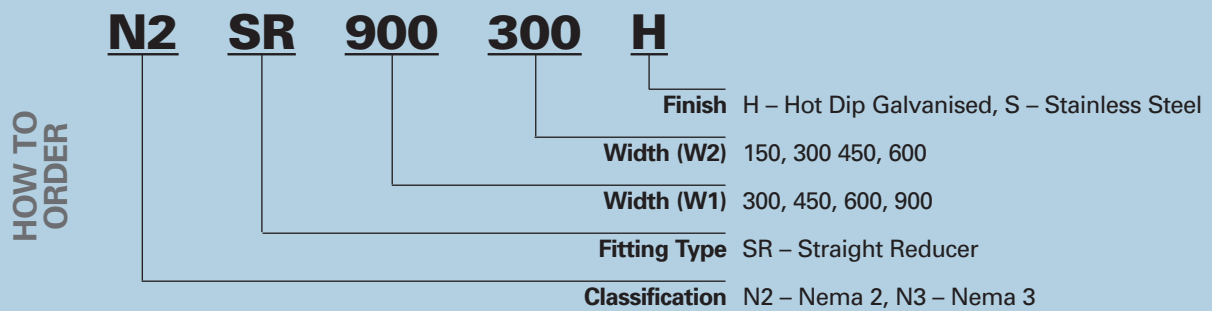

- 8 splice bolts (SBH or SBS) and splice nuts (SNH or SNS) should be ordered separately for installation.
- Reducers are manufactured against firm orders only.

Ordering Code	Cable laying depth		Length 1 (L1) mm	Length 2 (L2) mm
	Nema 2	Nema 3		
SR900600	75	115	100	300
SR900450	75	115	100	300
SR900300	75	115	100	300
SR900150	75	115	100	300
SR600450	75	115	100	300
SR600300	75	115	100	300
SR600150	75	115	100	300
SR450300	75	115	100	300
SR450150	75	115	100	300
SR300150	75	115	100	300

N2 – Nema 2 H – Hot Dip Galvanised
 N3 – Nema 3 S – Stainless Steel

NEMA 2&3

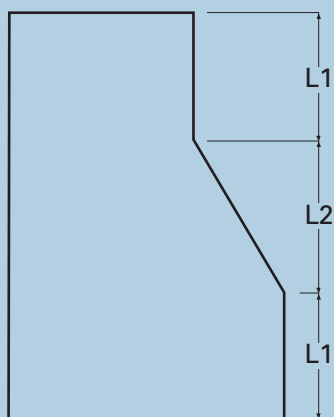

Length does not include built in splice plates.
Splice plate length 150mm.

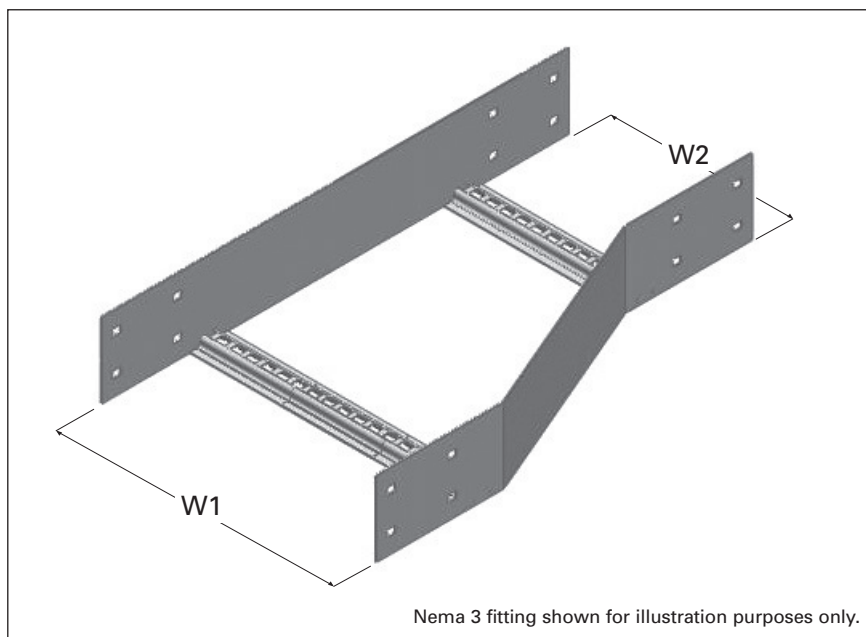

Nema 3 fitting shown for illustration purposes only.

CABLE LADDER LEFT HAND REDUCER

ORDERING DETAILS

Example for Nema 3 Left Hand Reducer 900 wide, reducing to 300 wide, Hot Dip Galvanised

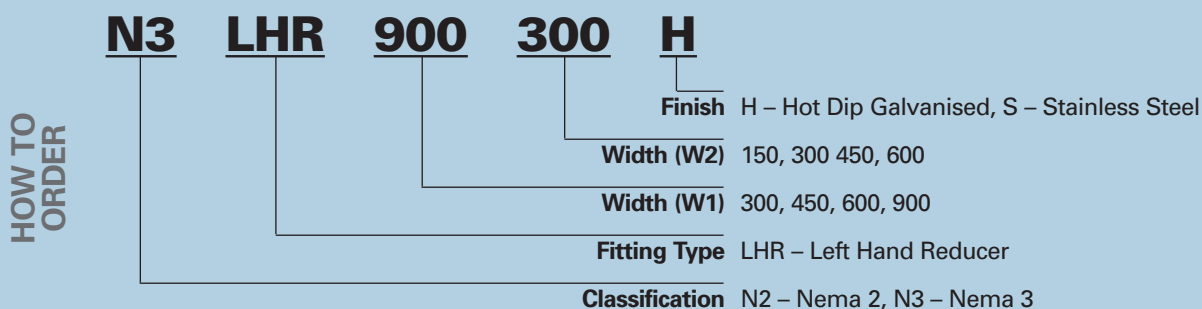

- 8 splice bolts (SBH or SBS) and splice nuts (SNH or SNS) should be ordered separately for installation.
- Reducers are manufactured against firm orders only.

Ordering Code	Cable laying depth		Length 1 (L1) mm	Length 2 (L2) mm
	Nema 2	Nema 3		
LHR900600	75	115	100	300
LHR900450	75	115	100	300
LHR900300	75	115	100	300
LHR900150	75	115	100	300
LHR600450	75	115	100	300
LHR600300	75	115	100	300
LHR600150	75	115	100	300
LHR450300	75	115	100	300
LHR450150	75	115	100	300
LHR300150	75	115	100	300

N2 – Nema 2
 N3 – Nema 3
 H – Hot Dip Galvanised
 S – Stainless Steel

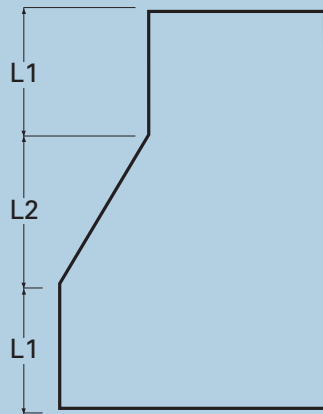

Length does not include built in splice plates.
Splice plate length 150mm.

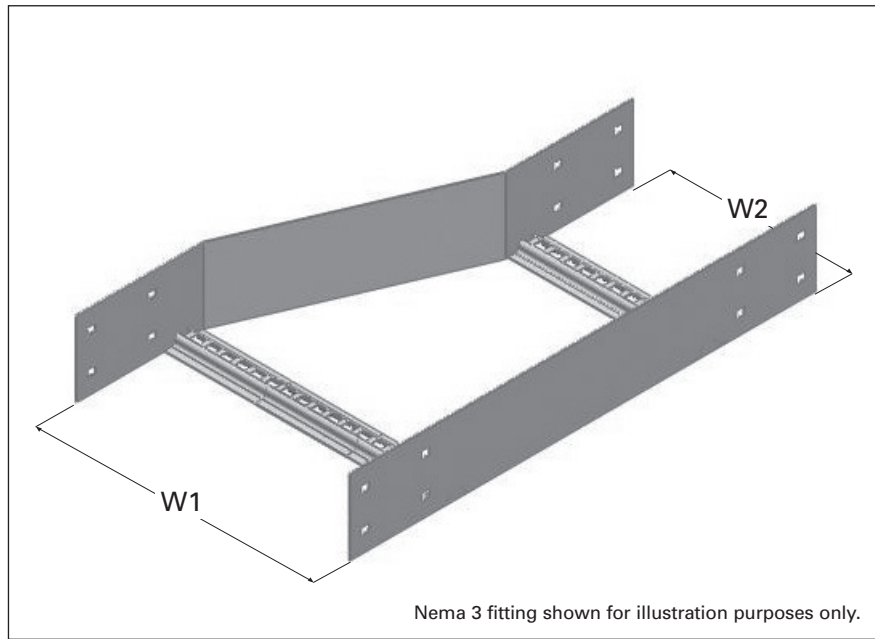

Nema 3 fitting shown for illustration purposes only.

CABLE LADDER RIGHT HAND REDUCER

ORDERING DETAILS

Example for Nema 2 Right Hand Reducer 900 wide, reducing to 300 wide, Hot Dip Galvanised

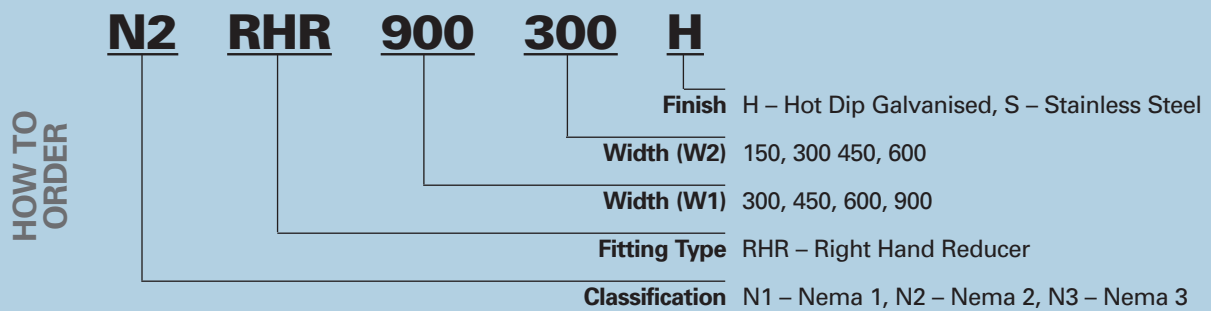

- 8 splice bolts (SBH or SBS) and splice nuts (SNH or SNS) should be ordered separately for installation.
- Reducers are manufactured against firm orders only.

Ordering Code	Cable laying depth		Length 1 (L1) mm	Length 2 (L2) mm
	Nema 2	Nema 3		
RHR900600	75	115	100	300
RHR900450	75	115	100	300
RHR900300	75	115	100	300
RHR900150	75	115	100	300
RHR600450	75	115	100	300
RHR600300	75	115	100	300
RHR600150	75	115	100	300
RHR450300	75	115	100	300
RHR450150	75	115	100	300
RHR300150	75	115	100	300

N2 – Nema 2 H – Hot Dip Galvanised
 N3 – Nema 3 S – Stainless Steel

PRODUCT DETAILS

EzyStrut cable ladder splices are manufactured from sheet steel to the following AS Standards:

- Mild Steel to AS/NZS1365 and Hot Dip Galvanised to AS/NZS4680, ISO1461
- Stainless Steel to AS1449, AS1837

ORDERING DETAILS

Available finish:

- H** – Hot Dip Galvanised
- S** – Stainless Steel

Stainless Steel products are manufactured against firm orders only. Minimum batch quantities may apply.

2 Splices required per length of cable ladder.

Order fasteners separately for installation

- 4 x SB__
- 4 x SN__

Ordering Code	To suit	Weight kg
N2S__	Nema 2	0.54
N3S__	Nema 3	0.69

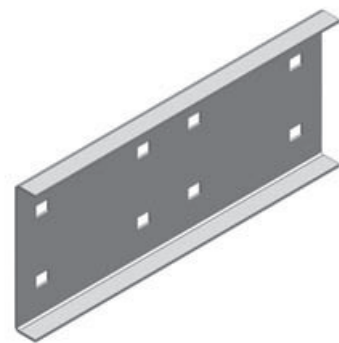

Nema 3 Splice shown for illustration purposes only.

SPLICE PLATE

2 Vertical Splices required per length of cable ladder.

Order fasteners separately for installation

- 4 x SB__
- 4 x SN__

Ordering Code	To suit	Weight kg
N2VS__	Nema 2	0.56
N3VS__	Nema 3	0.85

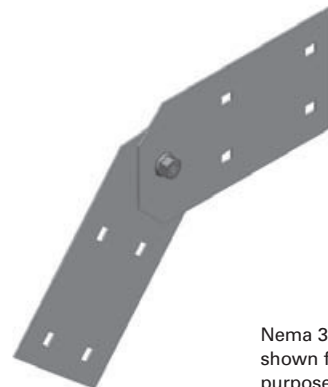

Nema 3 Vertical Splice shown for illustration purposes only.

VERTICAL SPLICE PLATE

2 Horizontal Splices required per length of cable ladder.

Order fasteners separately for installation

- 4 x SB__
- 4 x SN__

Ordering Code	To suit	Weight kg
N2HS__	Nema 2	0.60
N3HS__	Nema 3	0.86

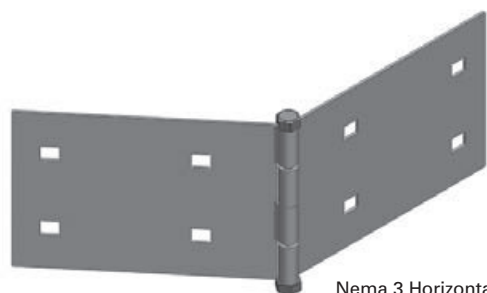

Nema 3 Horizontal Splice shown for illustration purposes only.

HORIZONTAL SPLICE PLATE

ORDERING DETAILS

Available finish:

- G** – Pre Galvanised (Galvabond)
(for Divider Strip only)
- Z** – Zinc Plated
(for standard hold down units only)
- H** – Hot Dip Galvanised
- S** – Stainless Steel

Stainless Steel products are manufactured against firm orders only. Minimum quantities may apply.

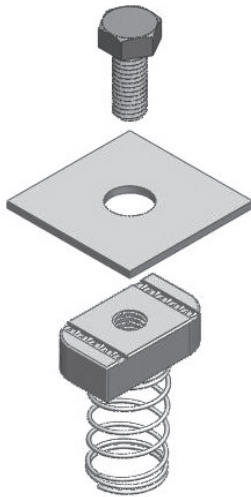

Supplied complete with hold down plate, spring nut and screw.
Hold down units are supplied with zinc plated fasteners as standard.

Ordering Code	To suit	Diameter	Weight kg
N2HDU__	Nema 2	M10	0.13
N3HDU__	Nema 3	M12	0.15

HOLD DOWN UNIT



Supplied complete with cone screw for installation.
Suitable for use on both cable ladders and fittings.

Ordering Code	To suit	Weight kg
N2CC__	Nema 2	0.12
N3CC__	Nema 3	0.14

COVER CLAMP

Standard Length – 2.4 metres
Standard finish – Pre Galvanised (Galvabond)

Hot Dip Galvanised Divider Strip is available to firm client orders, however we advise against the process on sheet metal products as product distortion is likely to occur as a result.

Ordering Code	To suit	Weight kg
N2DS__	Nema 2	1.11
N3DS__	Nema 3	1.59

DIVIDER STRIP

